

KWU for KS1150 Model

The Kitset Wall Unit (KWU) for the KS1150 models is a sheetmetal support structure designed to make the installation of the KS1150 Peninsula and the KS1150 LH-RH Corners more straightforward.

Once assembled, it will support wall cladding of up to 500kg without transferring load to the fire.

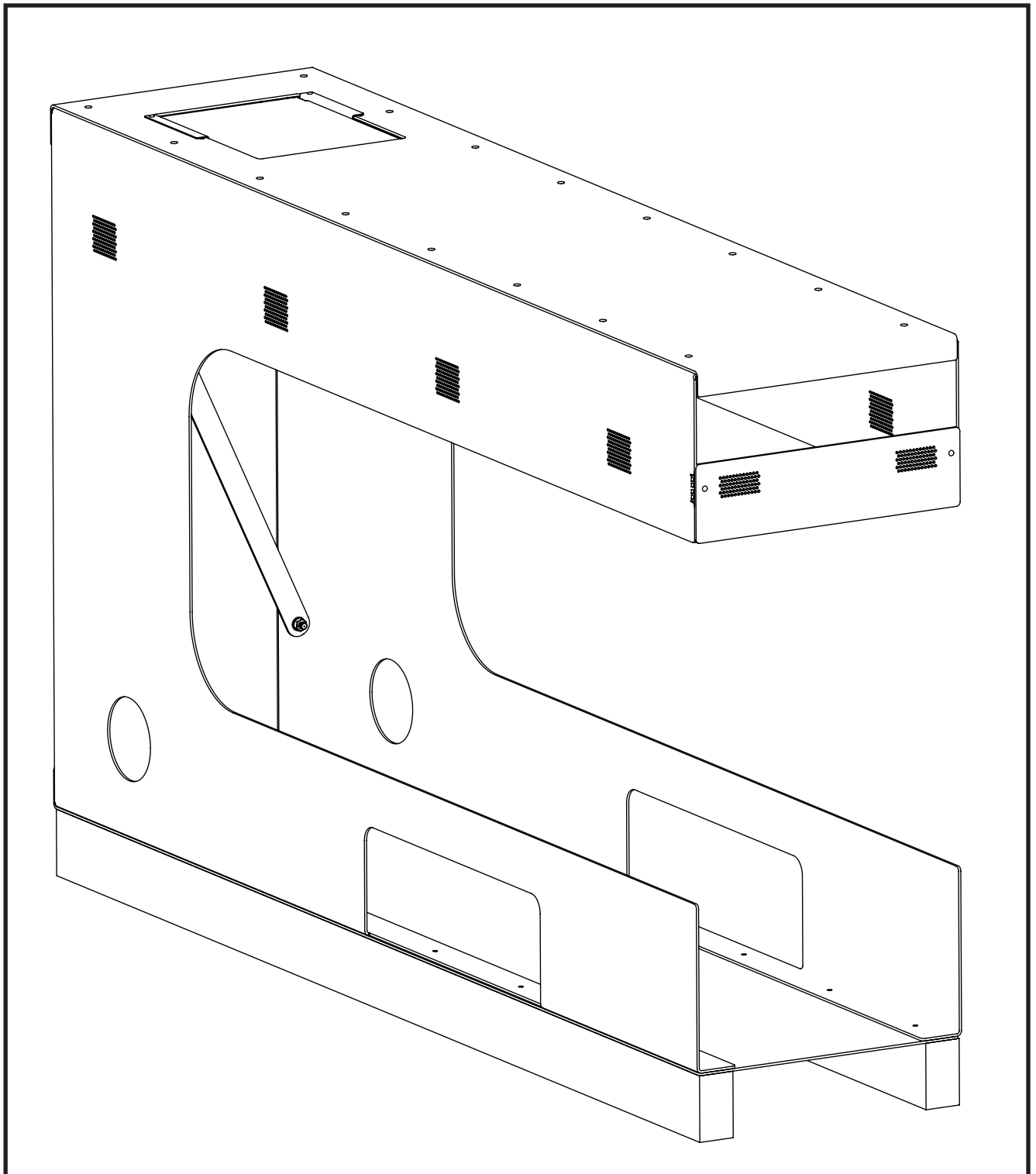

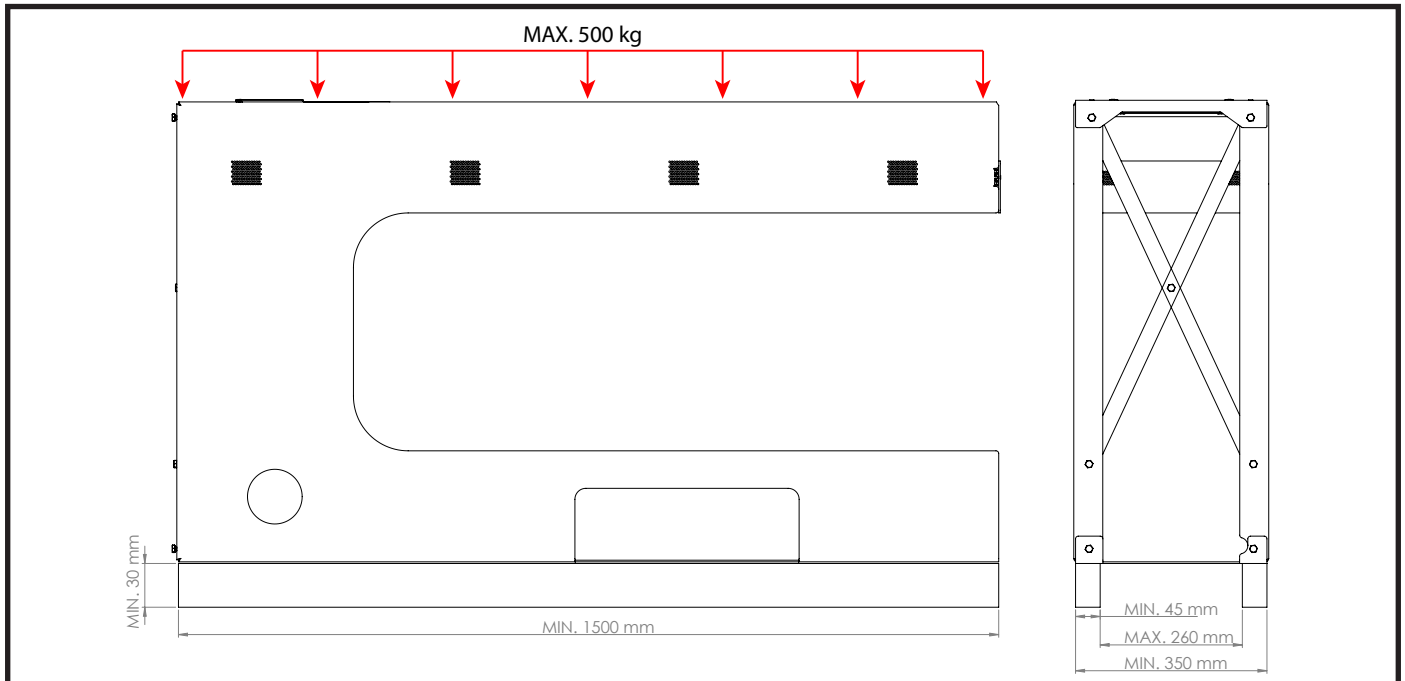

The KWU will need to be attached to timber framing with the dimension shown above (not supplied). Begin by setting the bottom on the timber. Set the left and right sides on top and affix using the 16 x #8-1 1/4 screws.

Package contains

Parts		Bolt/Nut/Washer
1	x Right side	16 x #8-1 1/4 Screws
1	x Left side	4 x #8-5/8 Screws
1	x Bottom	2 x M4 Washer
1	x Top	2 x M4 Nut
1	x End	18 x M6 Washer
2	x Hanger	18 x M6 Nut
1	x Lid	14 x M8 Washer
		7 x M8 Nut
		7 x M8 Bolt

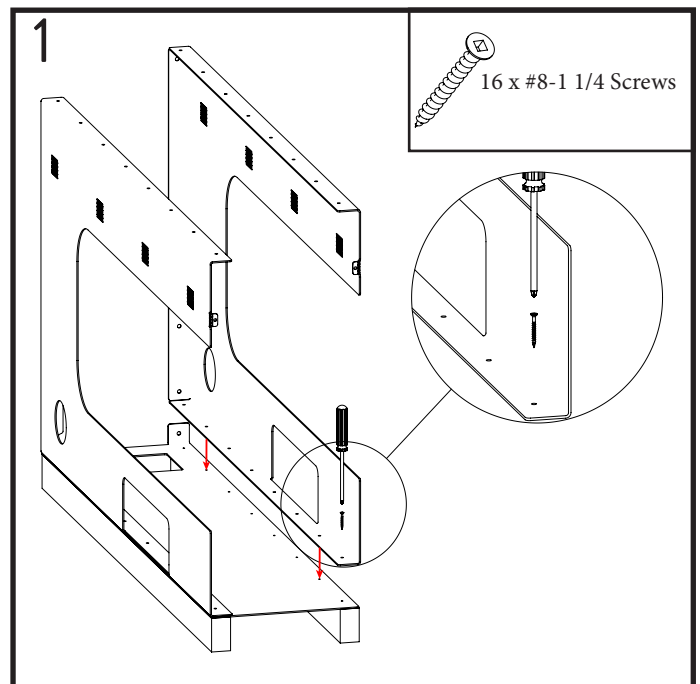

MODE

Accessory Installation Instruction

KWU for KS1150 Model

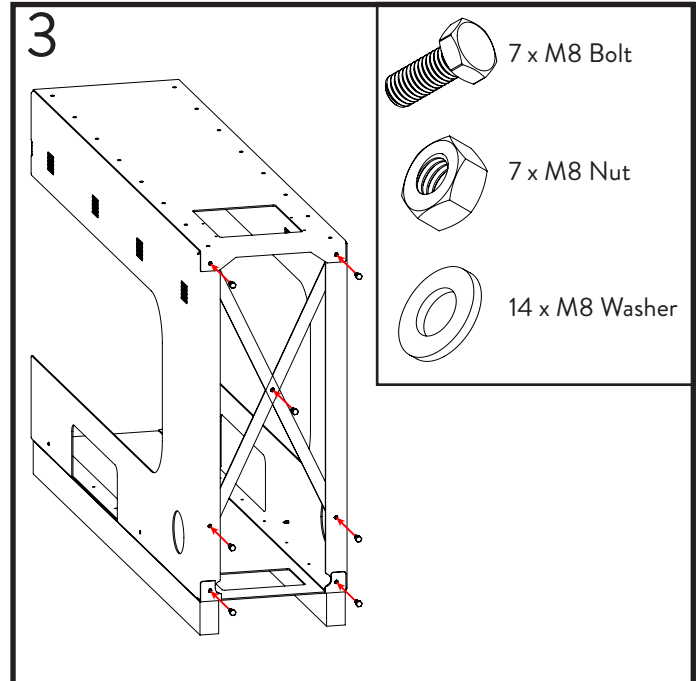
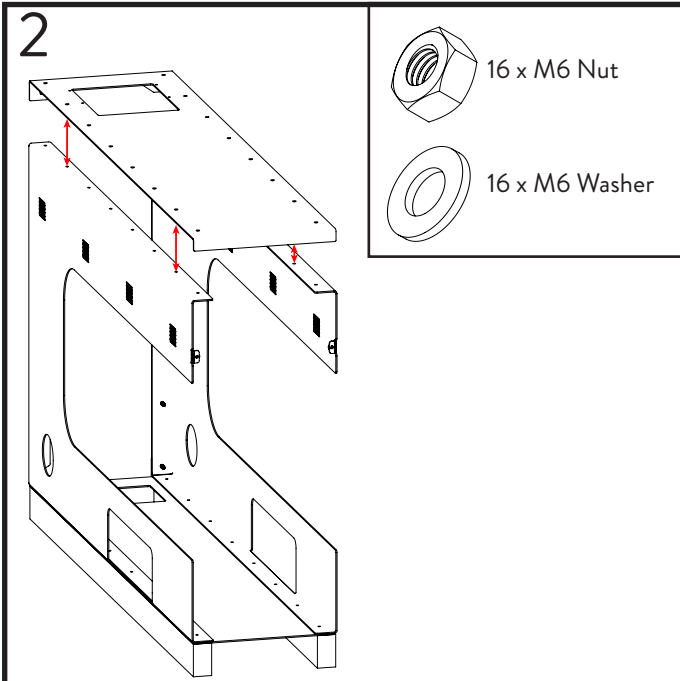

Set the top onto the two sides and affix. Attach the 2 x hangers as cross braces across the back. Slide the KS1150 Peninsula or KS1150 LH or RH Corner into the KWU. The holes on each side are to assist with access while sliding the fire in.

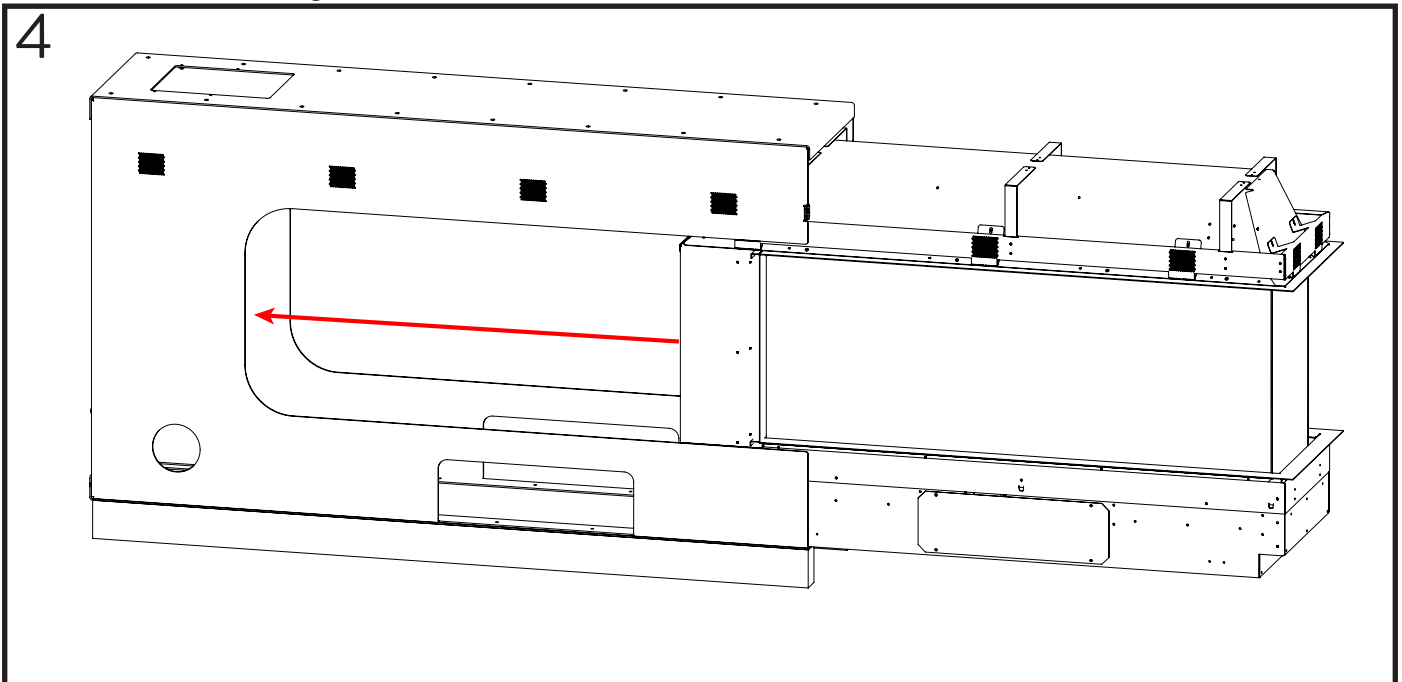

MODE

Accessory Installation Instruction

KWU for KS1150 Model

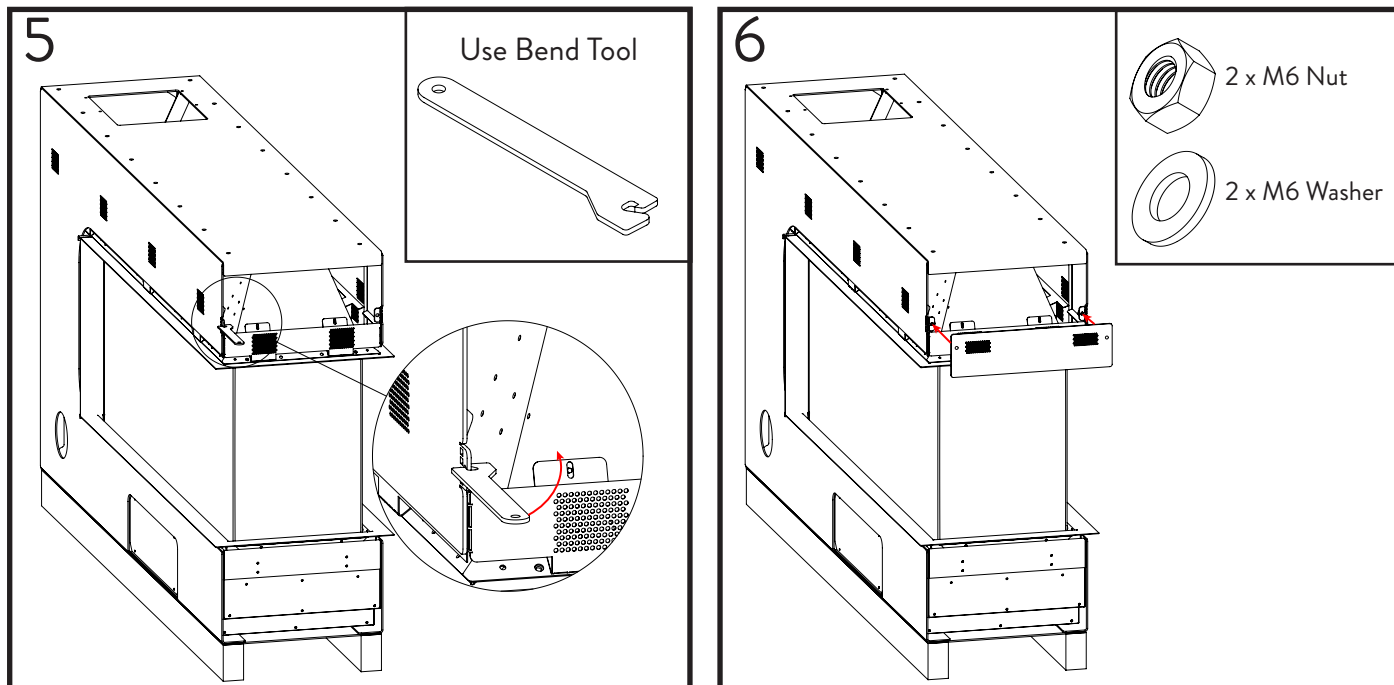

Use the supplied bend tool to bend the tabs on the top front of each side. Affix the front panel in place at the top. Use the supplied #8 - 5/8 screws to affix the KWU onto the fire (2 screws per side).

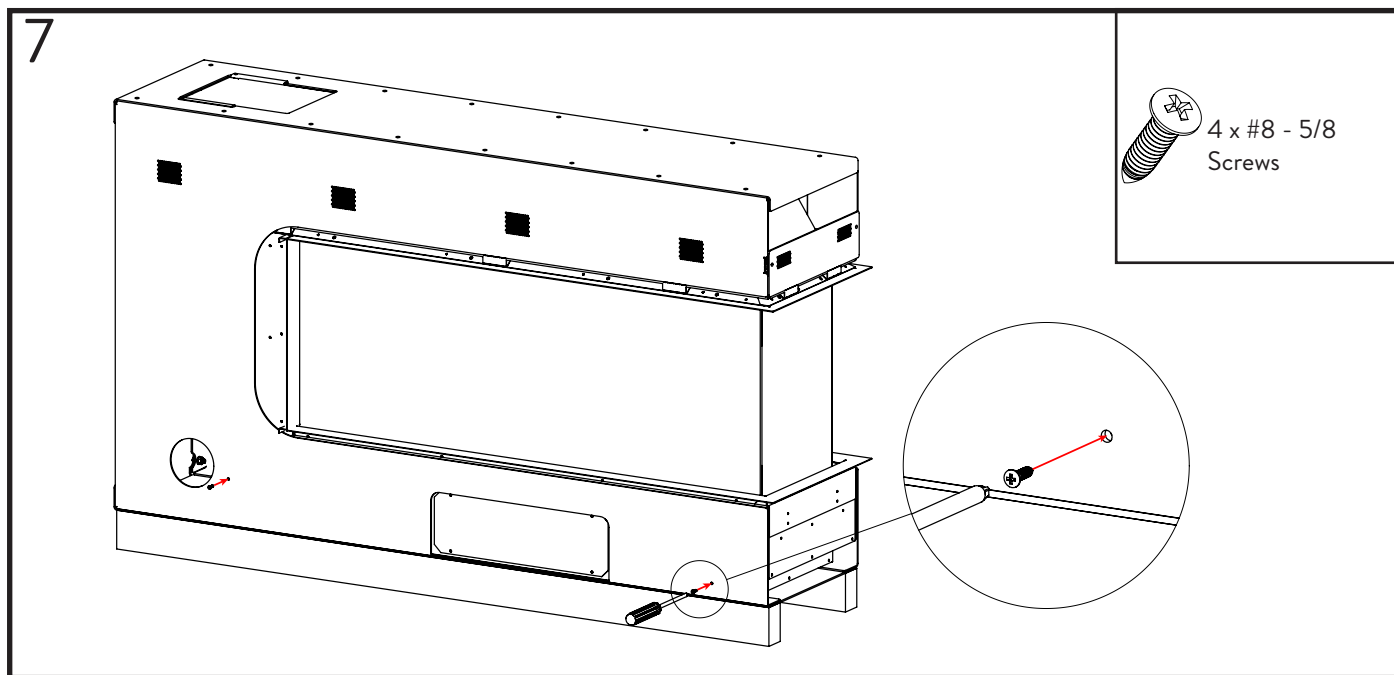

KWU for KS1150 Model

The top plate on the KWU can sit in one of two positions depending on the required flue position. Position 1 covers the entire opening on the top; position 2 covers half the opening with the plate sliding partway under.

8.1

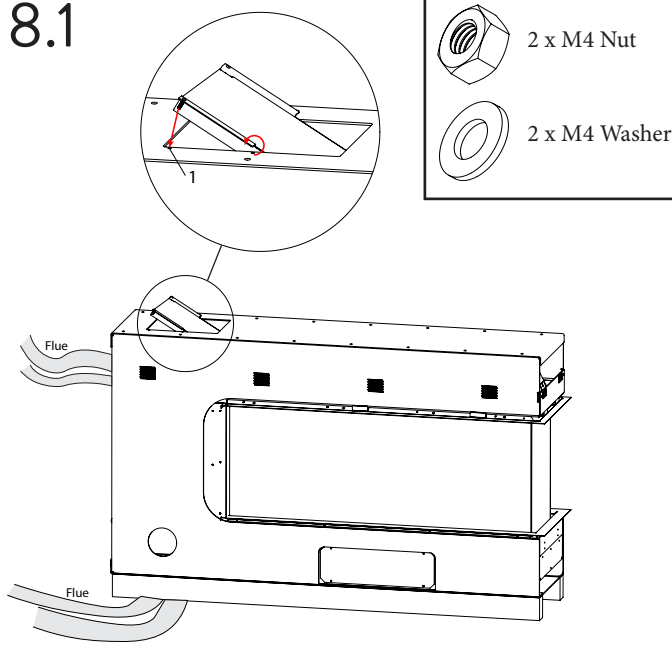

Flue out from the back or the bottom - use position 1.

8.2

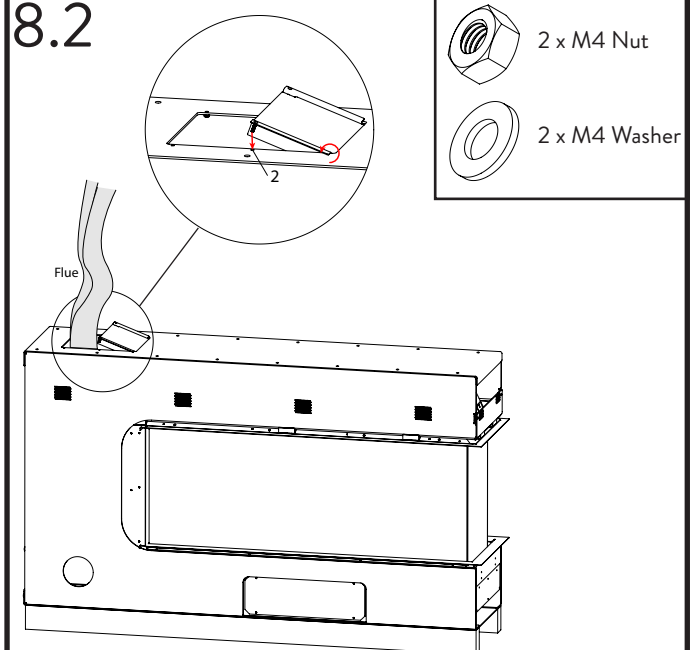

Flue out from the top - use position 2.

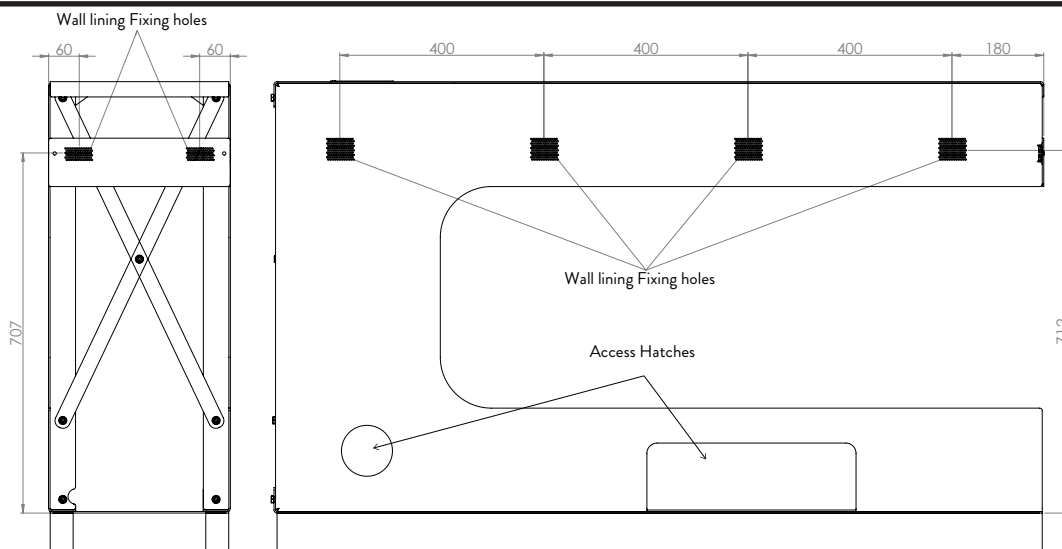

The wall lining fixing holes in the top of the KWU can be used for fixing plasterboard or wall cladding with either screws or construction adhesive glue. The access panels may be clad over; they do not need to remain accessible for service.

Recommended plasterboard screws: Scavenger Head/Bugle Head High Thread plasterboard screws, Size: 6 x (50mm MAX.)

WARNING: The maximum load supported by the KWU is 500kg. The attached wall cannot exceed this.