

Prolonged unprotected exposure to heat may be detrimental to the appearance or long term performance of the wall lining.

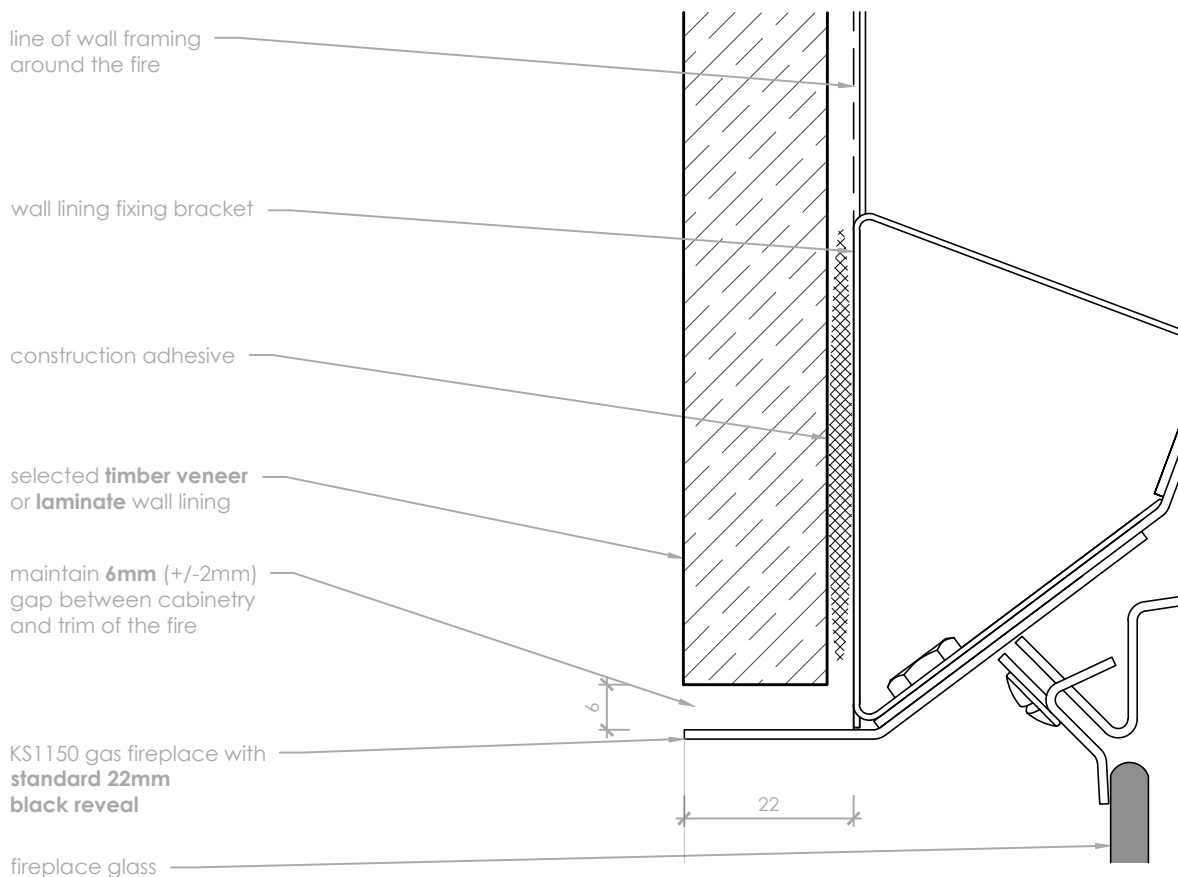

**Cabinetry Detail**

scale 1:1

**Notes:**

- All dimensions are in mm. DO NOT SCALE OFF THESE DRAWINGS
- This detail is to assist in the installation of a **frameless finish** to a Mode KS1150 Gas Fireplace. They offer pathways for protection of heat sensitive linings and finishes.
- Cabinetry panel can be directly bonded to the outer metalwork of the appliance.
- **Do not excessively push back lining when fixing it to the fire chassis** - use large daubs of adhesive to the appliance chassis, apply lining and flush finish with edge of the fire reveal.
- Black fireplace reveals must be able to be removed - ensure any adhesive or compound is kept clear.
- This technical sheet must be read in conjunction with the Mode KS1150 Installation Manual, the latest version can be found on our website at [www.stokefires.com](http://www.stokefires.com)

GENERAL CONSTRUCTION AND FINISHES SHOWN INDICATIVE ONLY

Contact the ESCEA Architectural Advisory Team for assistance with the specification of this fire - [aa@escea.com](mailto:aa@escea.com)