

Prolonged unprotected exposure to heat may be detrimental to the appearance or long term performance of the wall lining.

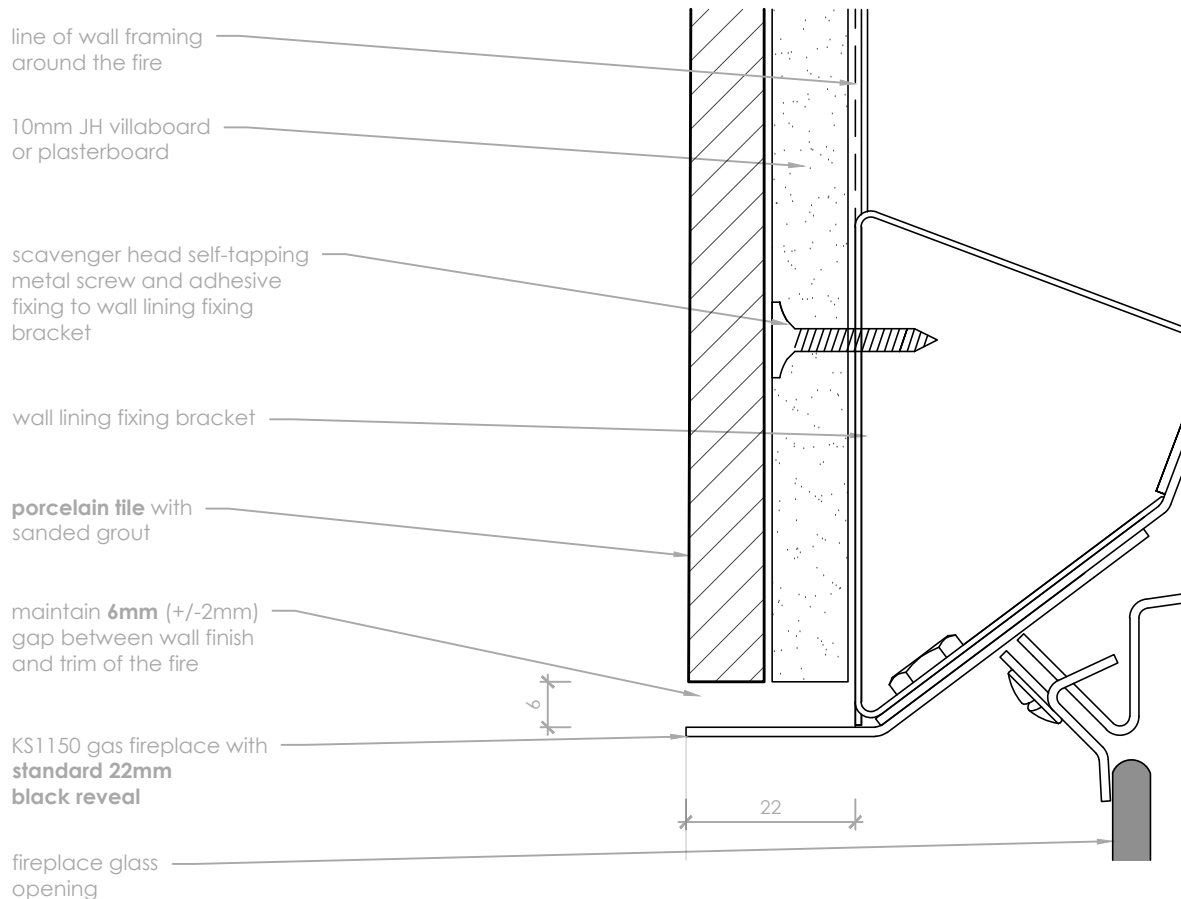

**Tile Detail**

scale 1:1

**Notes:**

- All dimensions are in mm. DO NOT SCALE OFF THESE DRAWINGS
- This detail is to assist in the installation of a **frameless finish** to a Mode KS1150 Gas Fireplace. They offer pathways for protection of heat sensitive linings and finishes.
- This detail will use the extended cabinetry trim kit to protect overhanging cladding edges at the opening of the fire.
- Escea recommends when using these finishing methods that **10mm Fibre Cement Sheet** is used.
- Use care when grouting tiles to avoid scratching black fireplace reveals.
- Black fireplace reveals must be able to be removed - ensure any adhesive or compound is kept clear.
- This technical sheet must be read in conjunction with the Mode KS1150 Installation Manual, the latest version can be found on our website at [www.stokefires.com](http://www.stokefires.com)

GENERAL CONSTRUCTION AND FINISHES SHOWN INDICATIVE ONLY

Contact the ESCEA Architectural Advisory Team for assistance with the specification of this fire - [aa@escea.com](mailto:aa@escea.com)